

Kit 1235

SUZUKI Aerio, 4-dr Sedan, 02-03, 04-07 / *02-07

SUZUKI Aerio, 5-dr Estate, 01-03, 04-07

SUZUKI Aerio SX, 5-dr Hatchback, *02-06

SUZUKI Aerio, 5-dr Wagon, *02-06

SUZUKI Liana, 4-dr Sedan, 02-03, 04-07

SUZUKI Liana, 5-dr Estate, 01-03, 04-07

*North America

480R
754

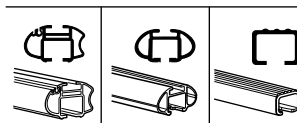
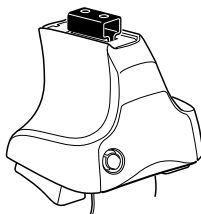

480

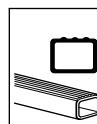
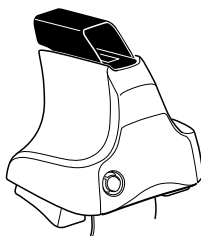

750

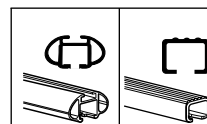
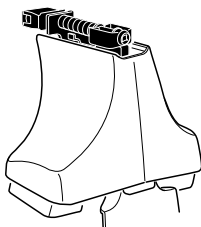

THULE[®]
SWEDEN

ISO 11154-E

| | | | | |
|----------------------|----|----------------------|----------|----|
| | | | | |
| x2 x2 x2 x4 | x2 | x2 x2 x4 x4 | x2 x2 | x2 |

← **368** x 2

← **410** x 2

← **07** x 2

← **53** x 2

x 1

Kit

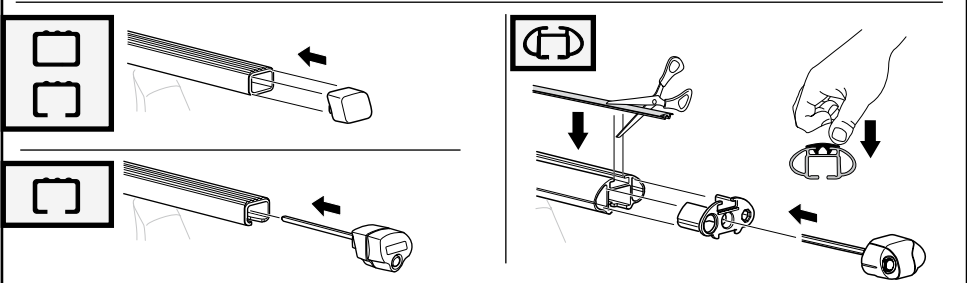
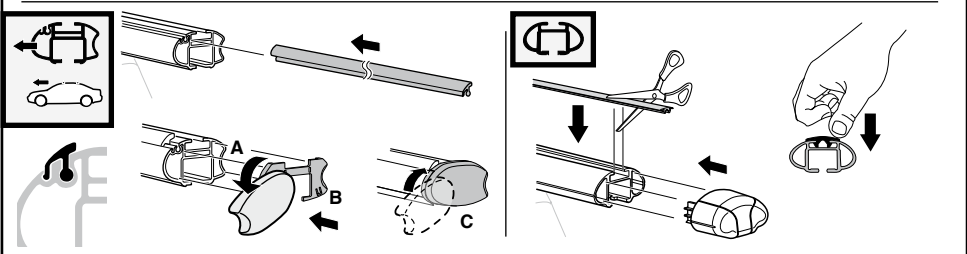
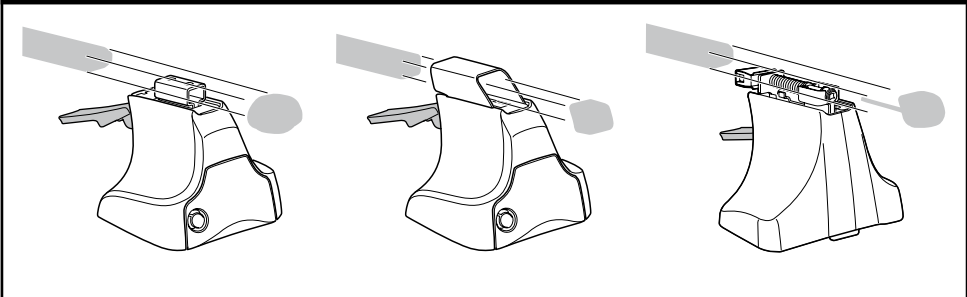

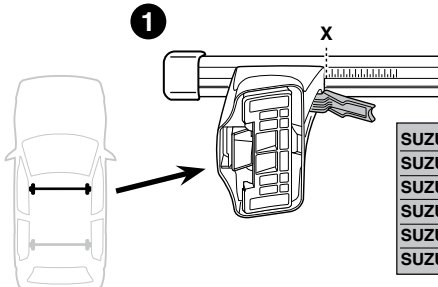
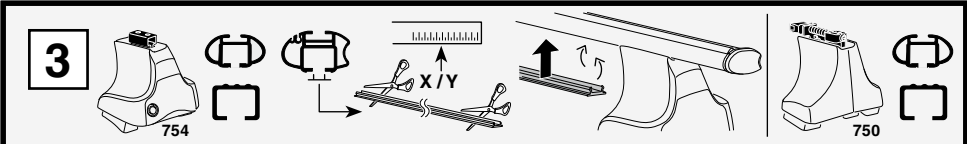

| | X |
|---|------|
| SUZUKI Aerio, 4-dr Sedan, 02-03, 04-07 / *02-07 | 34,5 |
| SUZUKI Aerio, 5-dr Estate, 01-03, 04-07 | 32,5 |
| SUZUKI Aerio SX, 5-dr Hatchback, *02-06 | 32,5 |
| SUZUKI Aerio, 5-dr Wagon, *02-06 | 32,5 |
| SUZUKI Liana, 4-dr Sedan, 02-03, 04-07 | 34,5 |
| SUZUKI Liana, 5-dr Estate, 01-03, 04-07 | 32,5 |

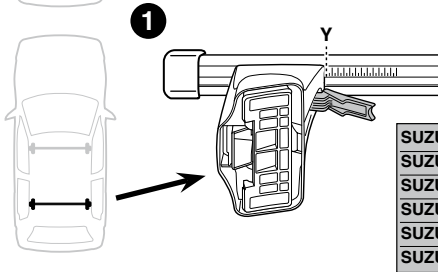

| | Y |
|---|------|
| SUZUKI Aerio, 4-dr Sedan, 02-03, 04-07 / *02-07 | 30 |
| SUZUKI Aerio, 5-dr Estate, 01-03, 04-07 | 28,5 |
| SUZUKI Aerio SX, 5-dr Hatchback, *02-06 | 28,5 |
| SUZUKI Aerio, 5-dr Wagon, *02-06 | 28,5 |
| SUZUKI Liana, 4-dr Sedan, 02-03, 04-07 | 30 |
| SUZUKI Liana, 5-dr Estate, 01-03, 04-07 | 28,5 |

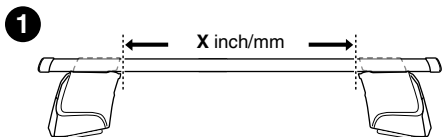
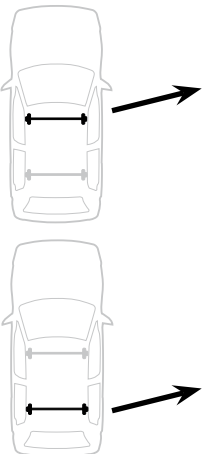
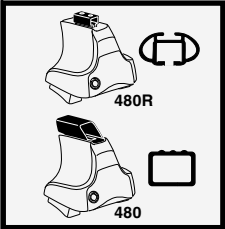

| | X inch | X mm |
|---|---------|--------|
| SUZUKI Aerio, 4-dr Sedan, 02-03, 04-07 / *02-07 | 39 1/4" | 996 mm |
| SUZUKI Aerio, 5-dr Estate, 01-03, 04-07 | 38 3/8" | 976 mm |
| SUZUKI Aerio SX, 5-dr Hatchback, *02-06 | 38 3/8" | 976 mm |
| SUZUKI Aerio, 5-dr Wagon, *02-06 | 38 3/8" | 976 mm |
| SUZUKI Liana, 4-dr Sedan, 02-03, 04-07 | 39 1/4" | 996 mm |
| SUZUKI Liana, 5-dr Estate, 01-03, 04-07 | 38 3/8" | 976 mm |

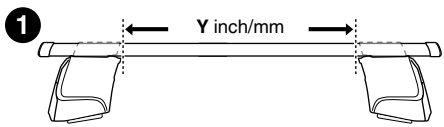

| | Y inch | Y mm |
|---|---------|--------|
| SUZUKI Aerio, 4-dr Sedan, 02-03, 04-07 / *02-07 | 37 1/2" | 951 mm |
| SUZUKI Aerio, 5-dr Estate, 01-03, 04-07 | 36 7/8" | 936 mm |
| SUZUKI Aerio SX, 5-dr Hatchback, *02-06 | 36 7/8" | 936 mm |
| SUZUKI Aerio, 5-dr Wagon, *02-06 | 36 7/8" | 936 mm |
| SUZUKI Liana, 4-dr Sedan, 02-03, 04-07 | 37 1/2" | 951 mm |
| SUZUKI Liana, 5-dr Estate, 01-03, 04-07 | 36 7/8" | 936 mm |

4

SUZUKI Aerio, 4-dr Sedan, 02-03, 04-07 / *02-07

SUZUKI Aerio, 5-dr Estate, 01-03, 04-07

SUZUKI Aerio SX, 5-dr Hatchback, *02-06

SUZUKI Aerio, 5-dr Wagon, *02-06

SUZUKI Liana, 4-dr Sedan, 02-03, 04-07

SUZUKI Liana, 5-dr Estate, 01-03, 04-07

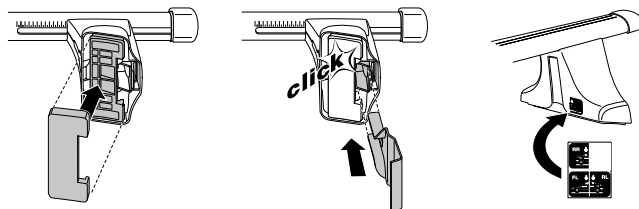
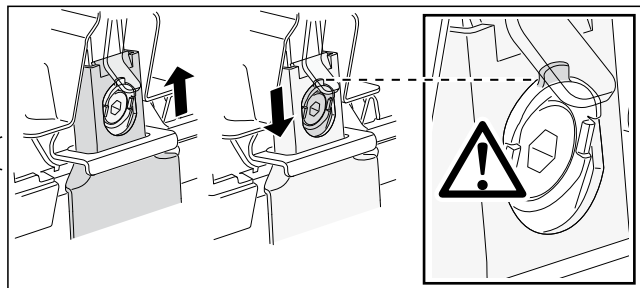
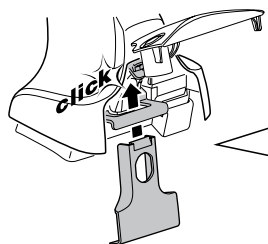
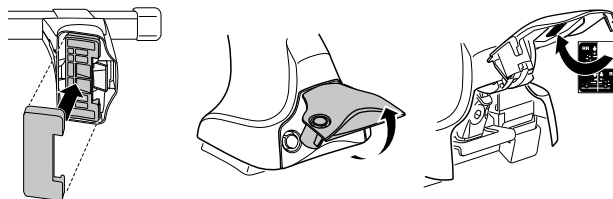
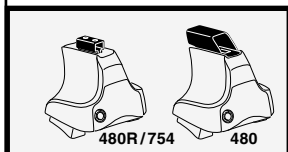
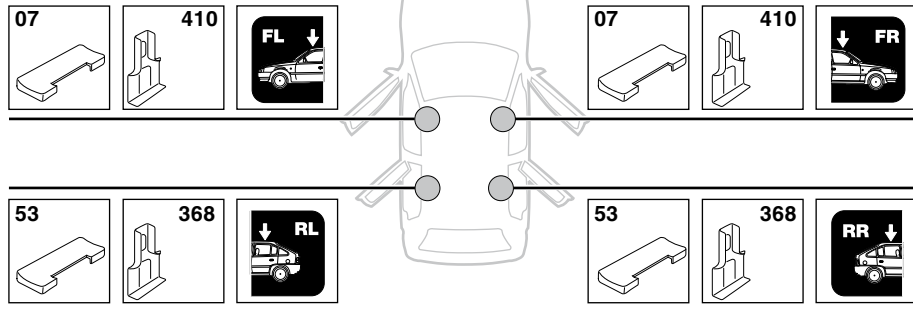

5

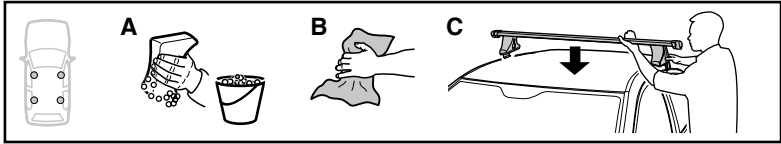

| | X mm | Y mm | X inch | Y inch |
|--|--------|--------|---------------------------------|----------------------------------|
| SUZUKI Aerio, 4-dr Sedan, 02-03, 04-07 / *02-077 | 250 mm | 700 mm | 9 ⁷ / ₈ " | 27 ¹ / ₂ " |
| SUZUKI Aerio, 5-dr Estate, 01-03, 04-07 | 355 mm | 700 mm | 14 " | 27 ¹ / ₂ " |
| SUZUKI Aerio SX, 5-dr Hatchback, *02-06 | 355 mm | 700 mm | 14 " | 27 ¹ / ₂ " |
| SUZUKI Aerio, 5-dr Wagon, *02-06 | 355 mm | 700 mm | 14 " | 27 ¹ / ₂ " |
| SUZUKI Liana, 4-dr Sedan, 02-03, 04-07 | 250 mm | 700 mm | 9 ⁷ / ₈ " | 27 ¹ / ₂ " |
| SUZUKI Liana, 5-dr Estate, 01-03, 04-07 | 355 mm | 700 mm | 14 " | 27 ¹ / ₂ " |

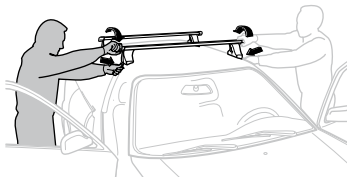
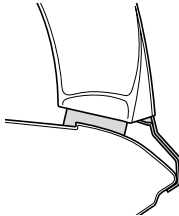
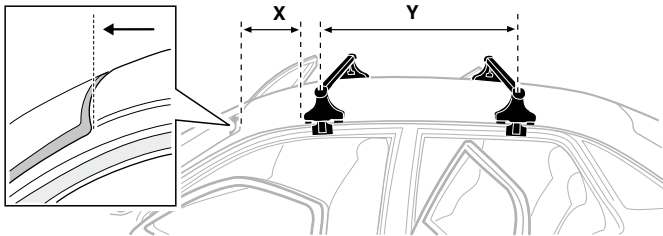

GB/US Tighten alternately

D Die Schrauben abwechselnd anziehen

F Serrer alternativement chaque côté

NL Afwisselend aan de linker- en de rechterkant aandraaien

I Alternare il serraggio delle viti

E Serrare alternativamente

PT Aperte alternadamente

S Dra åt växelvis

FIN Kierrä vuorotellen

EST Pinguldage vaheldumisi

LAT Pievelciēt pamišus

LIT Užsukinėkite pakaitomis

PL Śruby dokręcaj naprzemiennie

RU Затягивайте попеременно

CZ Pokręťta bagažníka dokręcaj dokręcaj naprzemiennie.

SK Doťahujte striedavo

SLO Privijajte izmenično.

HR Naizmjenično zategnite

HU Egymástól függetlenül szorítandó

GR Σφιγγετε εναλλάξ

TR Dönüşümlü sıkın

中文 交替拧紧

한국어 번갈아 가며 조이십시오.

日本語 交互に締め付けてください。

ไทย ชั้นโนแบบสลับ

6

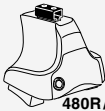

480R/754



480

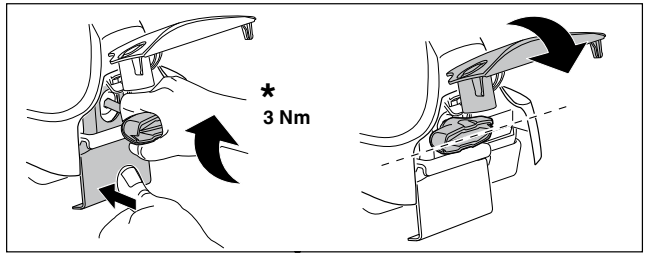
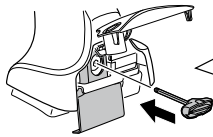

*
3 Nm

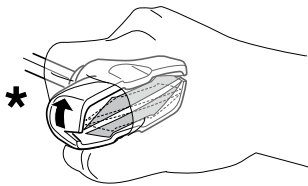

*

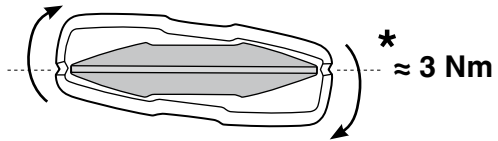

*
≈ 3 Nm

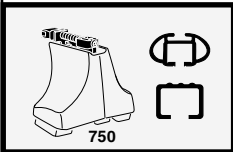
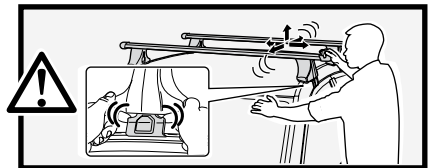

750

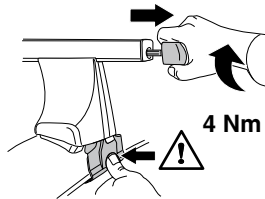

4 Nm

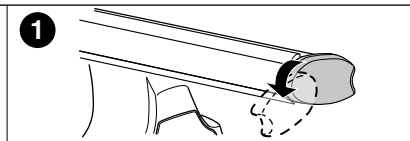
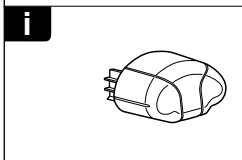
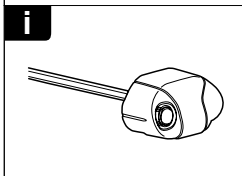
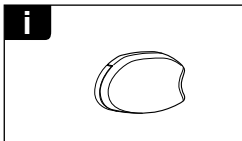
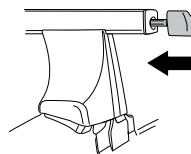

1

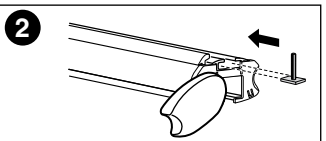

2

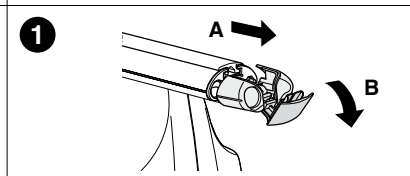

1

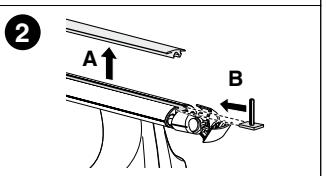

2

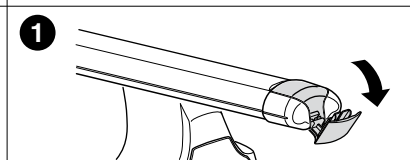

1

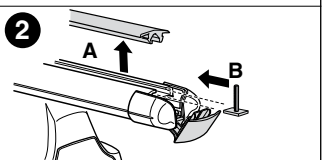

2

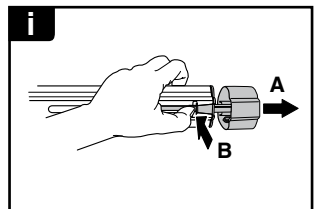
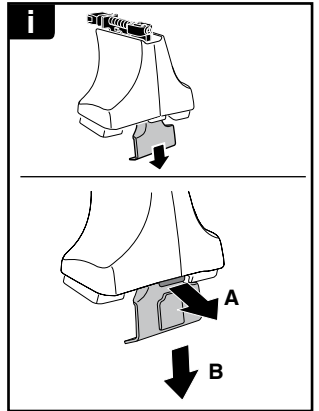
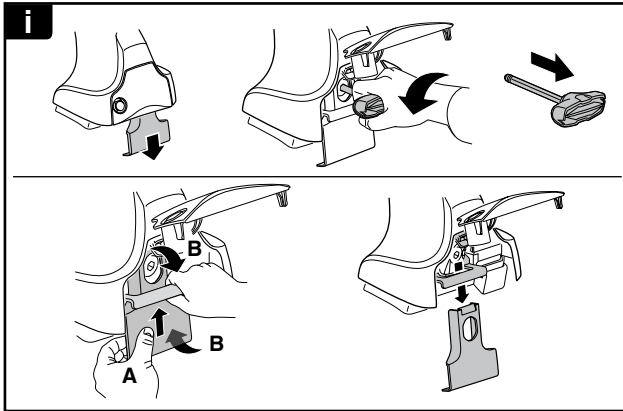
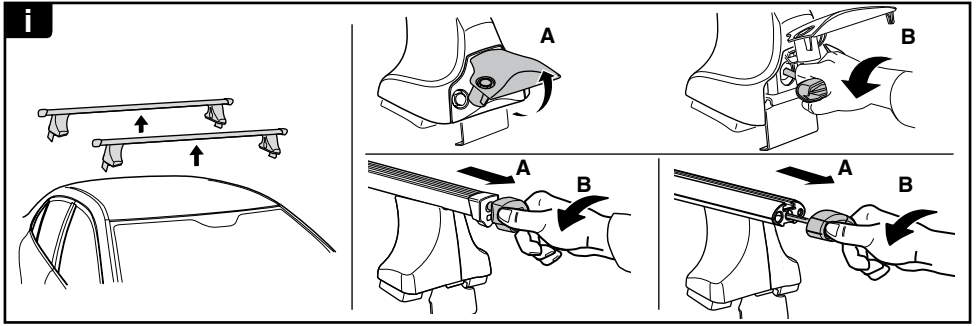

THULE
SWEDEN
**ONE
KEY
SYSTEM**

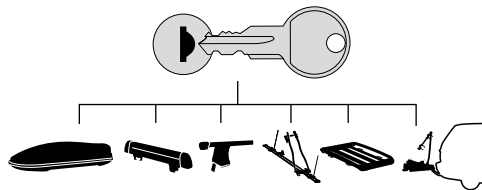

- 544 (x4)
- 596 (x6)
- 588 (x8)
- NA 510 (x10)
- EUR 452 (x12)
- ASIA

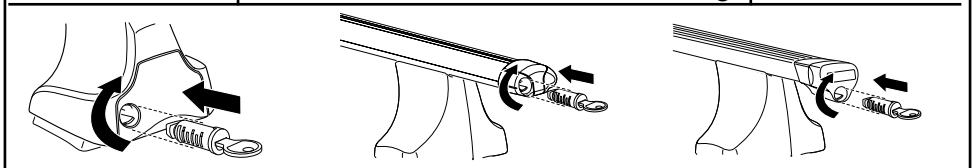

WW ▶ Thule Sweden AB, Box 69, 330 33 Hillerstorp, SWEDEN
NA ▶ Thule Inc., 42 Silvermine Road, Seymour, Connecticut 06483, USA

info@thule.com
customer.service@thule.com

www.thule.com